

6114600 N

6114500 N
303000 E

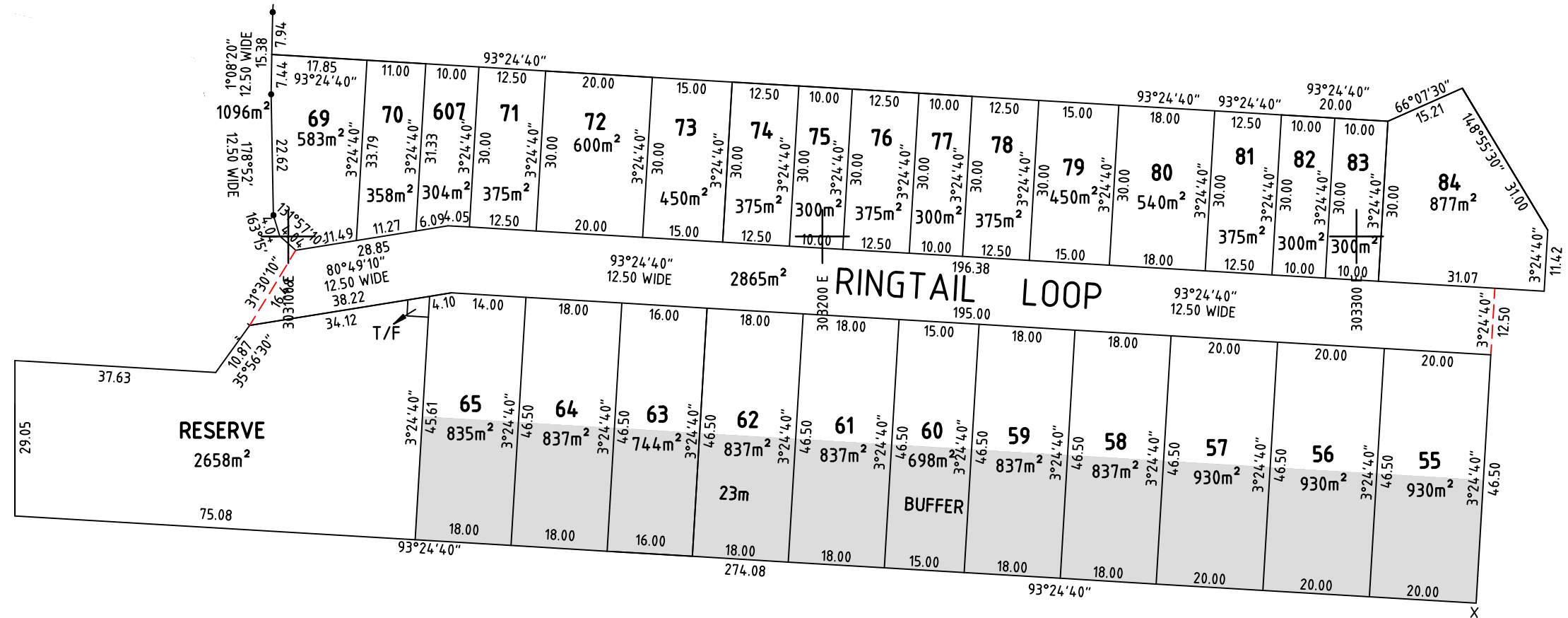

AD	21.01.2022	STAGE 8A - LOTS 68, 105 & PUMP STAGE 8B - LOTS 108, 114, 121 & 605	DEL	
REV	DATE	DESCRIPTION	CALC	FIELD
ADDITIONS, AMENDMENTS AND APPROVALS				



1:1000

Alexander & Symonds Pty Ltd
11 King William Street Kent Town,
South Australia 5067
PO Box 1000 Kent Town, SA 5071
ABN 93007 753 988

T (08) 8130 1666
F (08) 8362 0099
W www.alexander.com.au
E adelaide@alexander.com.au

+ Property + Land Development +
+ Construction + Mining +
+ Spatial Information Management +



CLOVER PARK MT BARKER PEGGING PLAN

DRAWING No. SHEET
20A1262CAD CLOVER ST8A Rev AD

REVISION
AD